

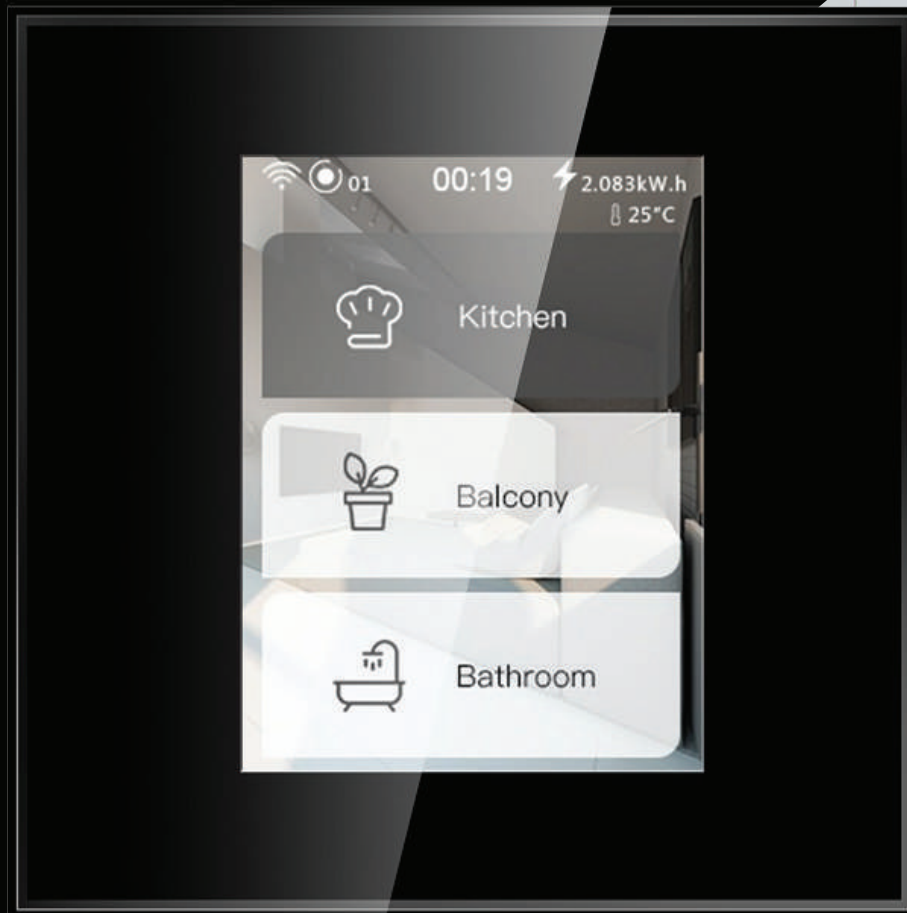

SMART HOME



An unprecedented interactive experience

Intelligent Technology

Smart Housekeeper

High Technology

Make a real smart living for you

Ultimate Integrated Wall Interaction

Fragmented home interaction environment becomes simple & beautiful

Interface Setting

Looks Beautiful & Elegant

Super mutual control

Any switch can be set for mutual control up to three groups

Power Consumption Statistics

Know power consumption at a glance

SMART



SWITCH

Fully interconnected

WiFi - MESH network

Scan Code Configuration

Scan QR code configuration network available

Scene Function

Scene setting function : User can create a scene in the App, one scene is mainly used to control multiple switches (switch can be arbitrarily added to a scene), scene function needs to be added on the App.

The advantage of the scene function is that you can turn on all the switches in one click. You can also set a scene via Siri on Iphone, no need to open the App.

Home Scene
All lights on



Party Scene
Colourful lights on

Leave Home Scene
All devices turn off



More scenes of your choice

Statistical Power Consumption

See your
Power Consumption
at a glance



The traditional wall switch is just a mechanical structure, it cannot show & monitor the device power consumption.



Switch built in precise power detection circuit.
Every switch can show the power consumption of the device it is connected

What's more is it can show the power consumption of the whole house & all the data is available for

Electricity Consumption of the day is

18.15 kW.h



8 Group Timing

With a simple setup, you can turn on/off the entire house light through the mobile app before sleep, saving the trouble of getting off the bed.

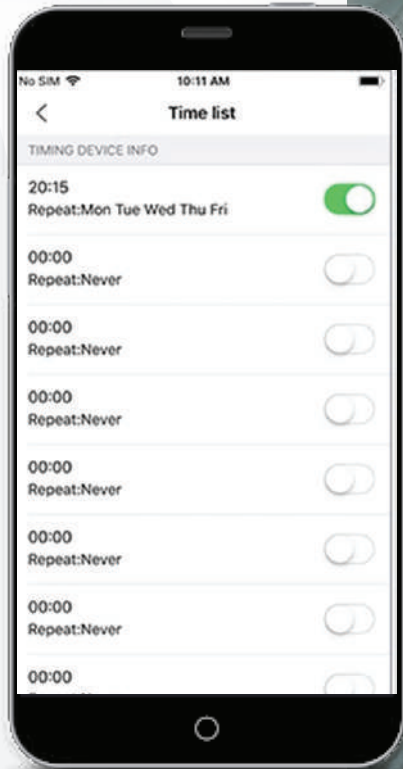

Between on/off
Life is smart.

7:00 am

Get Up Mode

10:00 pm

Go to Sleep Mode

9:00 am

Leave Home Mode

6:00 pm

Back Home Mode

Delay Function

Delay function : Setting the time to start running the switch. That is, the switch will automatically turn on or off after a period of time, the delay function will be valid once for each setting

7:00 am

Start Time

7:10 am

Turn off after
10 mins



Light Sensors



PRODUCTS

XA Switches



XA Switches



Have you encountered below troubles ?

Models are tedious

When purchasing, it often appears to buy less or more in all models, which is very inconvenient.

No text annotation

Made with plastic structure & no text labelling on switch causes inconvenience

Complicated installation

A separate linkage is required when you need mutual control on traditional switches

Unable to monitor electricity

As there is no display we cannot see the electrical consumption

Outdated Technology

Traditional switch based on Zigbee & WiFi technique, are big in built and cost high. The communication distance is short.

Complex Configuration

The configuration process consists of many steps and needs to operate by switch panel.

All these problems

are solved by XALIX



TECHNOLOGY PARTNER



COMPATIBLE WITH



POWERED BY



XALIX 

support@xalix.in 

www.xalix.in 

+91 7760810477/9731344362 

No 3040, (17/1), 3rd floor, BSYP Square,
14th Main, 8th Main Rd, 2nd Stage,
RPC Layout, Vijayanagar, Bengalore 560040 